

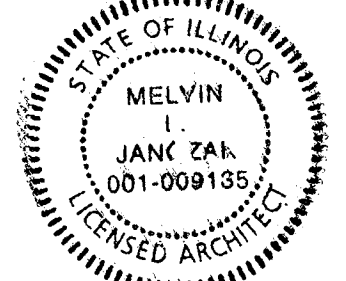

CURRENT DATE



RENEW EXP DATE

NO.	DATE	DESCRIPTION
B	4-2-03	PERMIT
A	3-31-03	BID
- PACKAGE DATE DESCRIPTION		

1374	JPK
PROJECT NO.	DRAWN
SCALE	CHECKED
1/8" = 1'	MLJ
TITLE	

**AQUATIC CENTER  
 AT THE EDGE  
 ON JOHN ST.  
 FLOOR PLAN**

**A-1**

**FLOOR PLAN NOTES**

- PROVIDE NEW DOUBLE-TIER 36" TALL VENTED ATHLETIC LOCKER W/ RECESSED STAINLESS STEEL HANDLE MECHANISM INCL. 5M. CLOSURES
- 16" HIGH X 36" DEEP CMU BASE W/ 4" DEEP CMU BASE W/ 4" POURED CONC. CAP - REFER TO DETAIL
- NEW 3' X 3' POURED CONCRETE SHOWER BASE W/ NON-SLIP CERAMIC TILE FINISH
- STARTING PLATFORM -- REFER TO PL-DWG.
- DIVING BOARD ASSEMBLY -- REFER TO PL-DWG.
- PRECAST BULLNOSE POOL COPING -- REFER TO PL-DWG.
- NON-SLIP CERAMIC TILE IN 1 1/2" CEMENT SET BED. PITCH TO DECK DRAINS -- 1/8" FT. TILE TO BE SELECTED BY OWNER.
- RELOCATE EXISTING OH. DOOR & PATCH WALL TO MATCH EXISTING. 8" CMU UGLAZED BLK. ACCENT STRIPES
- 2X4 ND6 TRENCH DRAIN BY POOL CONTR. FINAL CONNECTION TO WASTE PIPING BY PLUMBER -- REFER TO PL-2.
- RIGID STEEL FRAME STRUCTURE BY STL. CONTR. PAINT STEEL W/ 2 COATS OF EPOXY PAINT
- EXISTING STEEL COLUMNS TO REMAIN. REPAIR W/ EPOXY PAINT
- PROVIDE NEW OPENING IN EXISTING WALL FOR NEW ALUM. DOOR. INSTALL NEW STEEL LINTEL & PAINT LINTEL W/ EPOXY PAINT. PATCH WALL AS REQD.
- EXISTING DOORS TO REMAIN. REPAIR.
- NEW DECK DRAINS. REFER TO POOL PLANS FOR PIPING & RIM ELEVATIONS
86. SURGE WEIR GUTTER SYSTEM
- NEW DRINKING FOUNTAIN -- REFER TO PLEB. DWG.
- NEW 4" X 4" STEEL COLUMN & FOOTING -- REFER TO STRUCTURAL
- FLOOR FINISH TO BE NON-SLIP & PITCH TO FLOOR DRAINS AT MIN 1/8"
- EXISTING NO CHANGE
- NEW HOSE BIBS W/ V.B. -- REFER TO PLEB. PLANS
- 4X4 STEEL COLUMN TO SUPPORT LINTEL. REFER TO STRUCTURAL PLANS. PAINT W/ EPOXY PAINT.
- NEW DOWN SPOUTS
- PROVIDE 30" X 2' X 4' SUSPENDED ACOUSTICAL Baffles THROUGHOUT POOL AREA. HEIGHT @ 10'-0" AFF. TO BOTTOM OF Baffles
- 10" REIN. MASONRY PIERS -- REFER TO STRUCTURAL PLANS
- LINE OF AINING ABOVE
- EXISTING 8" CMU SCREEN WALL
- REMOVE EXISTING GYP. BD. CEILING & INSTALL NEW VINYL COATED GYP. BD. 2X4 LAY-IN CEILING SYSTEM. ALL MECHANICAL/ELECTRICAL DEVICES SHALL BE REMOVED AND REINSTALLED IN NEW CEILING SYSTEM

NOTE: REFER TO STRUCTURAL PLANS FOR ALL STRUCTURAL MEMBERS, DIMENSIONS, AND DETAILS.

**WINDOW TYPES--ALL HORIZ. MULLIONS TO MATCH EXISTING**

- G1 - 4 1/2" X 8" HIGH ALUM. SILL  
 4 1/2" X 2" ALUM. THERMO BRAKE  
 9'-0" TOTAL WIDTH (INCL. SILL & HEAD)  
 2 HORIZONTAL MULLIONS @ 3'-1" O.C.  
 1 VERTICAL MULLION @ CENTER  
 6 PANE 1" INSUL. GLASS -- 4'-1" X 2'-11"
- G2 - 4 1/2" X 8" HIGH ALUM. SILL  
 4 1/2" X 2" ALUM. THERMO BRAKE  
 10'-0" TOTAL WIDTH (INCL. SILL & HEAD)  
 2 HORIZONTAL MULLIONS @ 3'-1" O.C.  
 1 VERTICAL MULLION @ CENTER  
 12 PANE 1" INSUL. GLASS -- 4'-1" X 2'-11"
- G3 - 4 1/2" X 8" ALUM. SILL  
 4 1/2" X 2" ALUM. THERMO BRAKE  
 8'-9" TOTAL WIDTH  
 10'-0" TOTAL HEIGHT (INCL. SILL & HEAD)  
 2 - 2" HORIZONTAL MULLIONS @ 3'-1" O.C.  
 1 - 2" VERTICAL MULLION @ CENTER  
 6 PANE 1" GLASS -- 2'-10" X 2'-11"
- G4 - 4 1/2" X 8" ALUM. SILL  
 4 1/2" X 2" ALUM. THERMO BRAKE  
 12'-0" TOTAL WIDTH  
 10'-0" TOTAL HEIGHT (INCL. SILL & HEAD)  
 2 - 2" HORIZONTAL MULLIONS @ 3'-1" O.C.  
 2 - 2" VERTICAL MULLION @ 1/2 POINTS  
 6 PANE 1" GLASS -- 3'-9" X 2'-11"
- G5 - 4 1/2" X 8" ALUM. SILL  
 4 1/2" X 2" ALUM. THERMO BRAKE  
 3'-4" TOTAL WIDTH (INCL. FRAME)  
 7'-0" TOTAL HEIGHT (INCL. SILL & HEAD)  
 1 - 2" HORIZONTAL MULLION @ 3'-1" O.C.  
 2 PANE 1/4" TEMP. INSUL. GLASS -- 3'-0" X 2'-11"  
 1 PANE 1" INSUL. GLASS -- 12'-0" X 2'-11"
- G6 - 4 1/2" X 2" ALUM. FRAME  
 13'-0" TOTAL WIDTH (INCL. FRAME)  
 3'-0" TOTAL HEIGHT (INCL. SILL & HEAD)  
 1 PANE 1" TEMP. INSUL. GLASS -- 12'-0" X 2'-11"  
 (TRANSOM)

NOTE: ALL ALUM. FRAMES TO BE PAINTED BLUE TO MATCH EXISTING

- WALL TYPE E -- EXTERIOR WALLS**
- E-1 - 10" CMU BLOCK UGLAZED BLOCK ACCENTS AS PER ELEVATIONS  
 - HORIZONTAL BOND BM AT 8'-0" O.C. VERTICALLY  
 - HORIZONTAL REINFORCE W/ TRUSS TYPE DUROWALL REINFORCEMENT @ 16" O.C.  
 - GROUT CORE SOLID AND ANCHOR TO HORIZ. GIRTS  
 - FOAM INSULATION IN ALL OTHER CORERS OF BLOCK  
 - INTERIOR FINISHED W/ BLOCK FILLER AND ENAMEL PAINT
  - E-2 - 7" CORRUGATED VERTICAL METAL PANEL ATTACHED TO CMU WALL UGLAZED HAZ. SECTIONS @ 24" O.C.  
 - 10" CMU BLOCK CONSTRUCTION  
 - HORIZONTAL BOND BM AT 8'-0" O.C. VERTICALLY  
 - HORIZONTAL TRUSS TYPE DUROWALL REINFORCEMENT @ 16" O.C.  
 - GROUT CORE SOLID AND ANCHOR TO HORIZ. GIRTS  
 - FOAM INSULATION IN ALL OTHER CORERS OF BLOCK  
 - INTERIOR FINISHED W/ BLOCK FILLER AND ENAMEL PAINT
- WALL TYPE**
- 1 - 8" CMU BLOCK CONSTRUCTION  
 - HORIZONTAL TRUSS TYPE DUROWALL REINFORCEMENT @ 16" O.C.  
 - BLOCK FILLER W/ ENAMEL PAINT
  - 2 - 4" CMU BLOCK CONSTRUCTION  
 - HORIZONTAL TRUSS TYPE DUROWALL REINFORCEMENT @ 16" O.C.  
 - BLOCK FILLER W/ ENAMEL PAINT
  - 3 - 10" CMU BLOCK CONSTRUCTION  
 - HORIZONTAL TRUSS TYPE DUROWALL REINFORCEMENT @ 16" O.C.  
 - VERTICAL #5 AT 32" O.C. GROUT IN SOLID  
 - BLOCK FILLER W/ ENAMEL PAINT
  - 4 - 8" CMU BLOCK CONSTRUCTION UGLAZED BLOCK ACCENT TO ME.  
 - HORIZONTAL TRUSS TYPE DUROWALL REINFORCEMENT @ 16" O.C.

**HARDWARE SCHEDULE**

- 1 - 3 PAIR B.B. BUTTS  
 - PUSH/PULL HARDWARE TO MATCH  
 - 2 EA. CLOSURES W/ BACK CHECK  
 - ALUM. THRESHOLD (ADA)  
 - WEATHERSTRIP ALL SIDES  
 - DEAD BOLT INACTIVE LEAF IN JAMB  
 - PANIC PADDLE W/ DEAD BOLT
- 2 - 1 1/2 PR. B. B. BUTTS  
 - PANIC PADDLE W/ DEAD BOLT  
 - CLOSURE (LON)  
 - ALUM. THRESHOLD (ADA)  
 - WEATHERSTRIP 4 SIDES
- 3 - 1 1/2 PR. B. B. BUTTS  
 - PUSH/PULL HARDWARE  
 - BALL BEARING LATCH  
 - DEAD BOLT THUMB TURN POOL SIDE, KEY LOCKER SIDE  
 - CLOSURE
- 4 - 1 1/2 PR. B. B. BUTTS  
 - PUSH/PULL HANDLES  
 - CLOSURE
- 5 - 1 1/2 PR. B. B. NRP BUTTS  
 - PANIC PUSH BAR W/ FULL HANDLE OUTSIDE  
 - THRESHOLD ALUM. / ALUM. DRIP CAP  
 - CLOSURE / WEATHERSTRIP 4 SIDES
- 6 - 3 PR. B. B. BUTTS  
 - ACTIVE LEAF KNURLED LEVER STORE ROOM LOCK SET / ASTRICAL  
 - INACTIVE LEAF DEAD BOLT THB  
 - 2 CLOSURES W/ COORDINATOR  
 - ALUM. THRESHOLD
- 7 - RELOCATE EXISTING HARDWARE SYSTEM
- 8 - STANDARD CHAIN OPERATED FULL-UP HARDWARE W/ CHANNEL FRAME & WELDED RAILS

LINTEL6  
 L -- LINTEL -- REFER TO STRUCTURAL PLANS

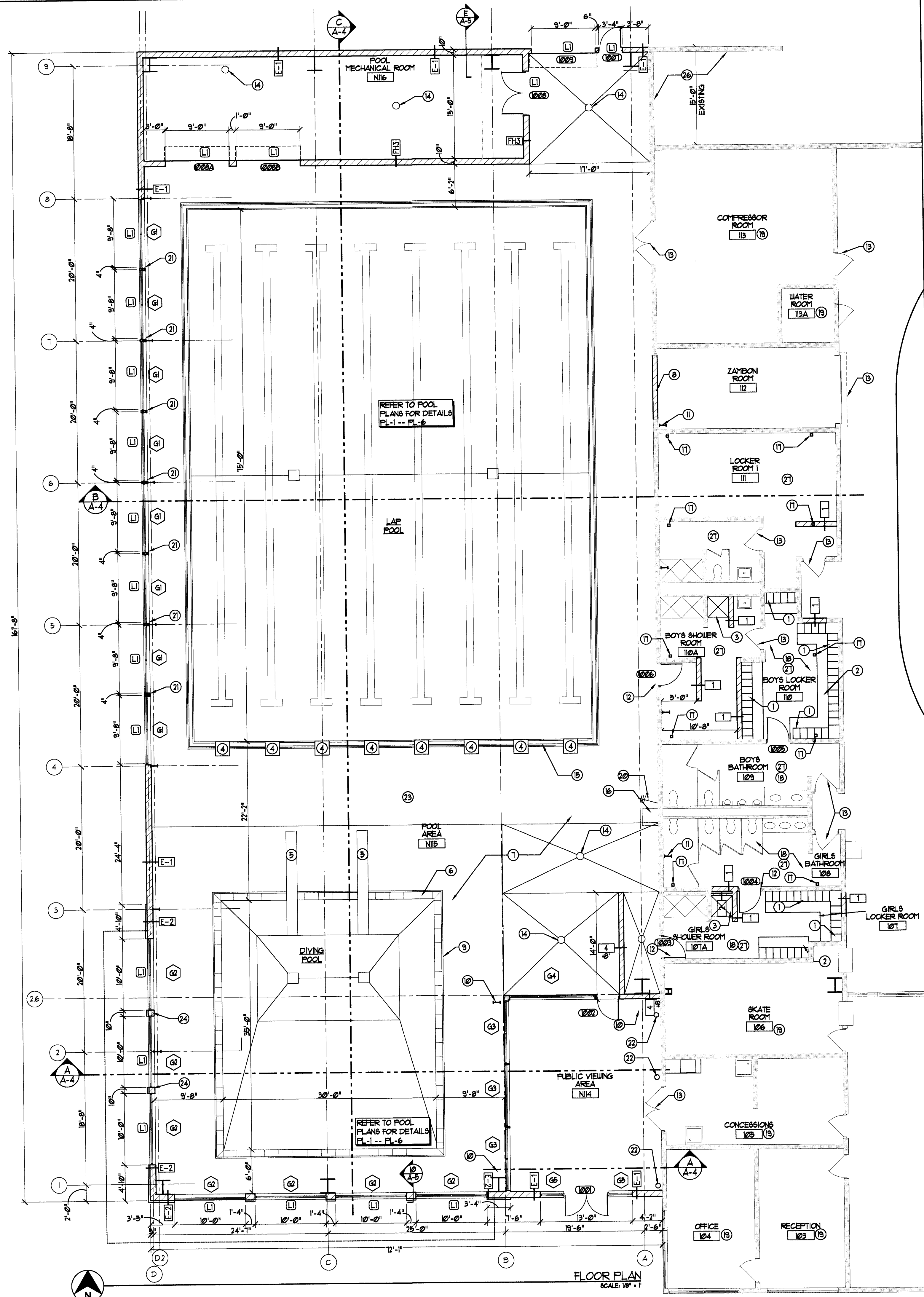

NO.	DOOR		FRAME						LABEL	HDW	GLASS	REMARKS
	SIZE	THK	MATL.	ELEV.	MATL.	ELEV.	HEAD	JAMB				
1001	(2) 3'-0" X 7'-0"	1 3/4"	ALUM.	-	ALUM.	-	2X4 1/2	2X4 1/2	ALUM.	1	1/4" TEMP	-
1002	3'-0" X 7'-0"	1 3/4"	ALUM.	-	ALUM.	-	2X4 1/2	2X4 1/2	ALUM.	2	1" INS	-
1003	3'-0" X 7'-0"	1 3/4"	ALUM.	-	ALUM.	-	4X4 1/2	2X4 1/2	NONE	3	1/4" TEMP	OBSCURE GLASS
1004	3'-0" X 7'-0"	1 3/4"	ALUM.	-	ALUM.	-	4X4 1/2	2X4 1/2	NONE	4	1/4" TEMP	OBSCURE GLASS
1005	3'-0" X 7'-0"	1 3/4"	ALUM.	-	ALUM.	-	4X4 1/2	2X4 1/2	NONE	4	1/4" TEMP	OBSCURE GLASS
1006	3'-0" X 7'-0"	1 3/4"	ALUM.	-	ALUM.	-	4X4 1/2	2X4 1/2	NONE	3	1/4" TEMP	OBSCURE GLASS
1007	3'-0" X 7'-0"	1 3/4"	H.M.	-	H.M.	-	4X5 3/4	2X5 3/4	ALUM.	5	-	-
1008	6'-0" X 7'-0"	1 3/4"	H.M.	-	H.M.	-	4X5 3/4	2X5 3/4	ALUM.	6	-	-
1008A	9'-0" X 8'-0"	1 3/4"	METAL	-	STEEL	-	STL. PL.	MC 10X8.4	NONE	8	-	INSULATED ROLL-UP
1008B	9'-0" X 8'-0"	1 3/4"	METAL	-	STEEL	-	STL. PL.	MC 10X8.4	NONE	8	-	INSULATED ROLL-UP
1009	9'-0" X 9'-0"	EXIST.	EXIST.	-	EXIST.	-	STL. PL.	MC 10X8.4	NONE	7	-	EX. ZAM. ROOM DOOR, RELOCATED

NO.	ROOM	FLOOR	WALL								CEILING		NOTES
			NORTH	SOUTH	EAST	WEST	MATL.	FINISH	HEIGHT	MATL.	FINISH		
106	SKATE ROOM	EXISTING	EXISTING	EXISTING	EXISTING	EXISTING	EXISTING	EXISTING	EXISTING	EXISTING	EXISTING	EXISTING	-
107	GIRLS LOCKER ROOM	C.T.	C.T.	EXISTING	EXISTING	EXISTING	EXISTING	EXISTING	EXISTING	EXISTING	EXISTING	EXISTING	-
107A	GIRLS SHOWER ROOM	C.T.	C.T.	EXISTING	EXISTING	EXISTING	EXISTING	EXISTING	EXISTING	EXISTING	EXISTING	EXISTING	-
108	GIRLS BATHROOM	C.T.	C.T.	EXISTING	EXISTING	EXISTING	EXISTING	EXISTING	EXISTING	EXISTING	EXISTING	EXISTING	-
109	BOYS BATHROOM	C.T.	C.T.	EXISTING	EXISTING	EXISTING	EXISTING	EXISTING	EXISTING	EXISTING	EXISTING	EXISTING	-
110	BOYS LOCKER ROOM	C.T.	C.T.	EXISTING	EXISTING	EXISTING	EXISTING	EXISTING	EXISTING	EXISTING	EXISTING	EXISTING	-
110A	BOYS SHOWER ROOM	C.T.	C.T.	EXISTING	EXISTING	EXISTING	EXISTING	EXISTING	EXISTING	EXISTING	EXISTING	EXISTING	-
112	ZAMBONI ROOM	EXISTING	C.T.	EXISTING	EXISTING	EXISTING	EXISTING	EXISTING	EXISTING	EXISTING	EXISTING	EXISTING	-
N114	PUBLIC VIEWING AREA	C.T.	C.T.	EXISTING	EXISTING	EXISTING	EXISTING	EXISTING	EXISTING	EXISTING	EXISTING	EXISTING	-
N115	POOL AREA	C.T.	C.T.	EXISTING	EXISTING	EXISTING	EXISTING	EXISTING	EXISTING	EXISTING	EXISTING	EXISTING	-
N116	POOL MECHANICAL ROOM	EXP. CONC	VINYL	EXISTING	EXISTING	EXISTING	EXISTING	EXISTING	EXISTING	EXISTING	EXISTING	EXISTING	-